

# THE BANKHILL

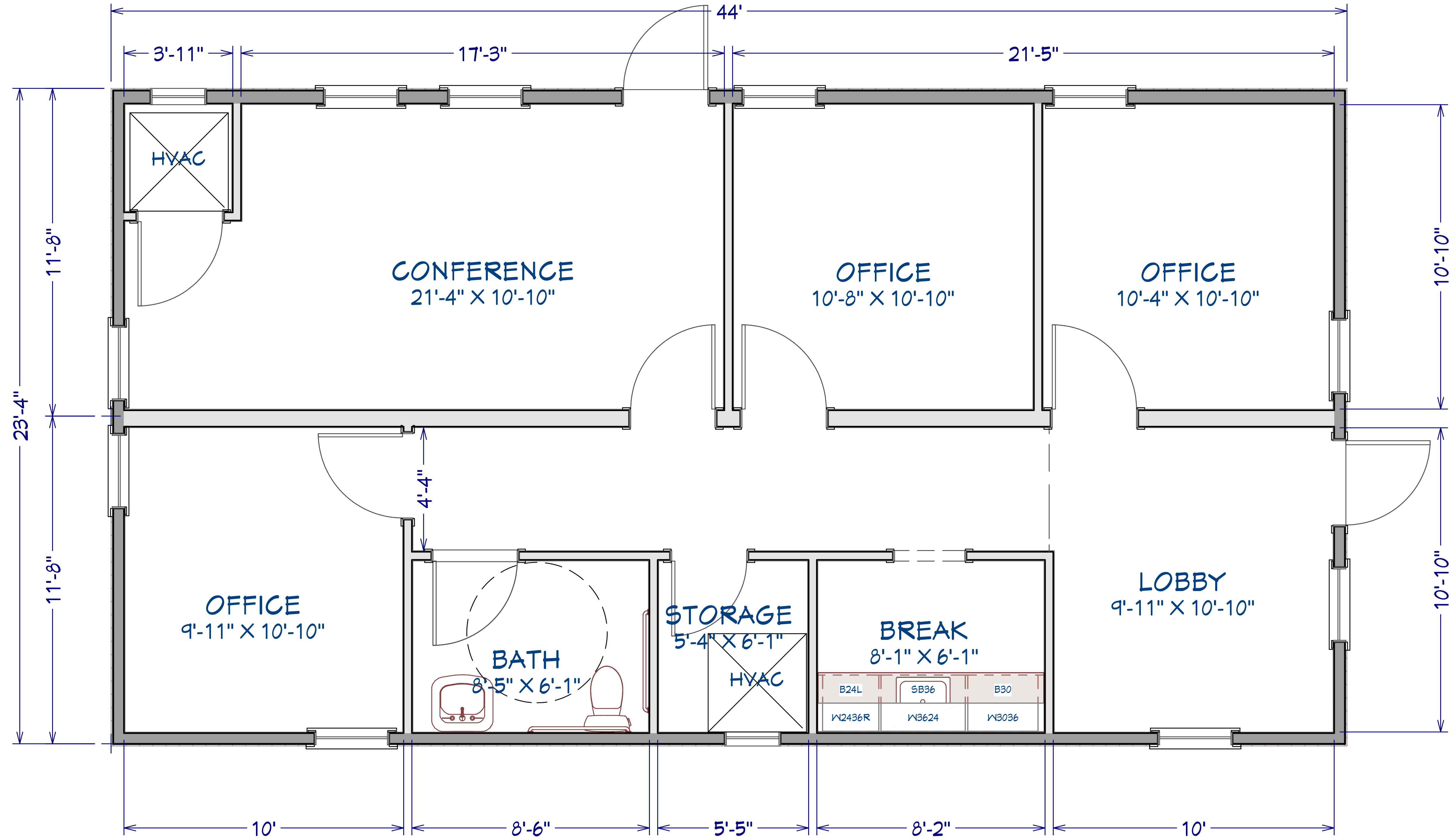

**SQUARE FOOTAGE**  
1020 SQ FT

| NUMBER | DATE | REVISION BY | DESCRIPTION |
|--------|------|-------------|-------------|
|        |      |             |             |
|        |      |             |             |
|        |      |             |             |

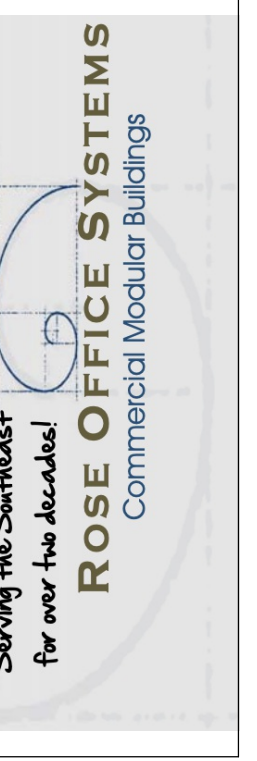

**THE BANKHILL**  
24X44 OFFICE

DRAWINGS PROVIDED BY:  
ROSE OFFICE SYSTEMS  
PO BOX 608 SAGINAW, AL 35197  
(888) 608-1175  
WWW.ROSEOFFICES.COM

DATE:

10/28/19

SCALE:

1/2" = 1'-0"

SHEET:

P-1